

Welcome to your Rotary Spreader



For a quick, easy and even application of Miracle-Gro® lawn food and seed products

To view our assembly videos use the QR code, or to find spreader settings visit lovethegarden.com/spreadersettings



How to assemble

1. Lay the spreader down so it rests on its front. Insert hooks of the frame legs into the designated black frame slots.
2. Place spreader upright, straighten handle and tighten wing nuts.
3. Make sure the window for the spreader settings is facing forward when the spreader is upright.

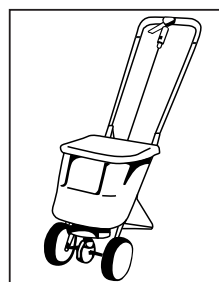
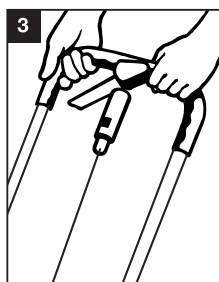
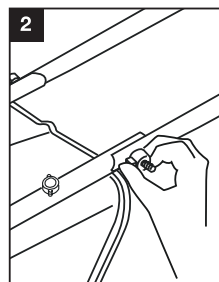
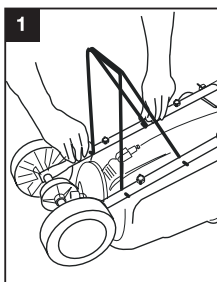

Your Rotary Spreader is now ready to use.

For easy storage, just reverse the process.

Useful Tips

1. Use when weather is fair and not windy, because if lawn feed granules are blown onto a flower bed, they may harm your plants.
2. Ensure the spreader is shut off when not in use. This means the hole at the base of the hopper is closed.
3. Ensure product is brushed off your shoes before stepping onto pavement etc. If the lawn was wet before application, make sure your shoes are cleaned and dried before stepping onto pavement.

How to use

Application rates can vary depending on the product, its setting and walking speed, so it is best to time your walking speed before you apply the product.

1. Cover 1m per second.

Measure a distance 5m apart and walk between the two points pushing an empty spreader. Practice until it takes you 5 seconds to cover the distance. This is the speed you need to walk whilst applying the product.

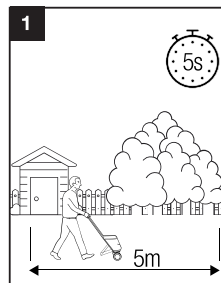
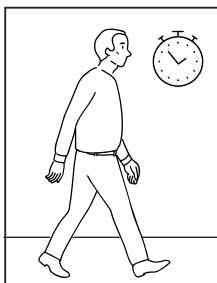

2. Check the spreader is fully operational.

Release handle to off position, with the lever positioned away from the handle. This ensures the hole in the hopper is closed. The spreader is now shut off and no product can be released.

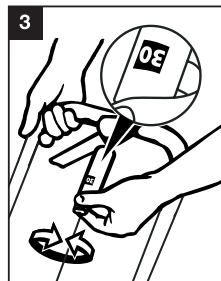
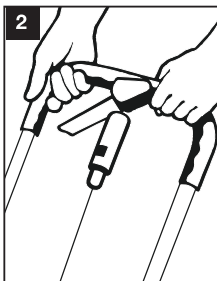

3. Select the right setting.

This spreader has been tested and calibrated to work with our range of Miracle-Gro® lawn food and seed products only. Visit lovethegarden.com/spreadersettings for a full list of our products and their settings.

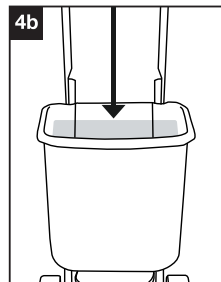
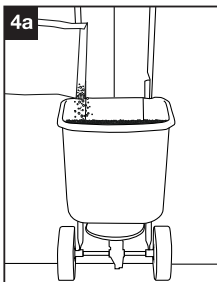

4a. Fill the spreader.

To fill the hopper always place the spreader on a level surface, and not on the lawn. You want to avoid excess product falling onto the lawn to avoid scorching. Sweep up any product that falls on your patio as staining may occur.

4b. Fill the hopper evenly up to three quarters of its capacity. As a handy visual guide there is a line separating the rough and the smooth surface.

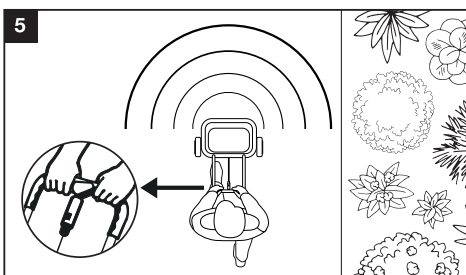

5. Begin spreading.

As you begin walking pull the handle back towards you. Product will spread on to the lawn as you walk. The rotary spreader has a reach of 3m. Do not use product that contains weed or moss control around ornamental plants or within 3m of borders as damage may occur.

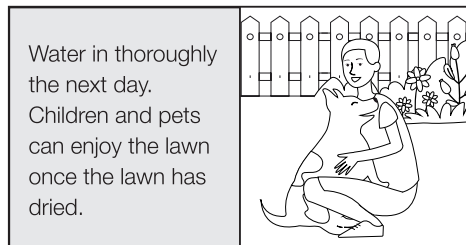

Water in thoroughly the next day.

Children and pets can enjoy the lawn once the lawn has dried.

How to apply

The number of passes vary depending on the product and spreader used. Visit lovethegarden.com/spreadersettings for a full list of products and their passes, when using a rotary spreader.

Begin with your borders.

1. Whether your lawn is square or irregular shaped you need to first apply a header strip by running your spreader along the border of the lawn.
2. Be sure to leave a 3m gap from your border, as this is the spreading width.
3. When changing directions always release the handle which shuts off the spreader, so no product is released. This is to avoid over application and scorching your lawn.

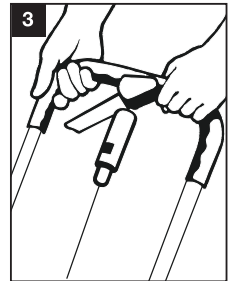
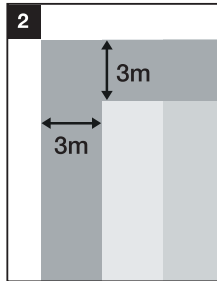
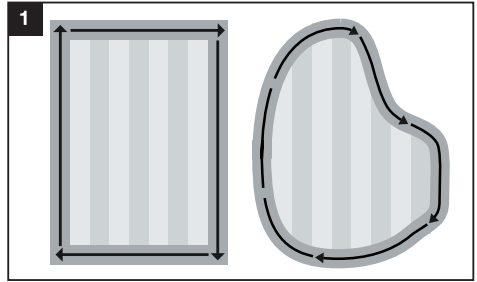

Inside portion of your lawn.

4. Walk your spreader back and forth in the longest direction shutting off the spreader when reaching the header strip you just completed and change directions.
5. If the product setting requires two or more passes over the lawn, cover the lawn area in different directions, criss-cross, this will avoid tramlines between each row where no product has fallen.

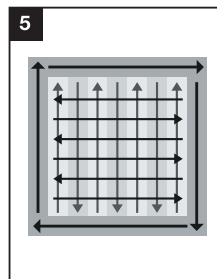
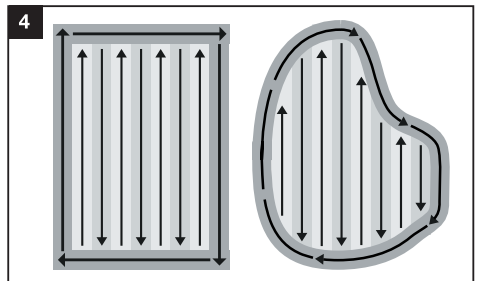

Maintenance

1. Never leave product in the spreader as it may dampen and clog up the spreader, leading to parts rusting earlier than necessary.
2. Pour leftover product back into the original packaging, seal tightly and store in a dry place.
3. After each use, wash the spreader thoroughly over the lawn to remove all product (avoid this waste water from entering the drainage system).
4. Once the spreader is dry use a light spray lubricant around the axle (do not over grease).
5. Store the spreader and product in a dry location.

Spreaders will require calibration every year to ensure the spreader settings are accurate. For more maintenance tips and calibration instructions scan the QR code below to watch our videos.

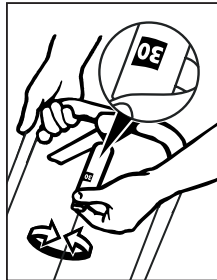
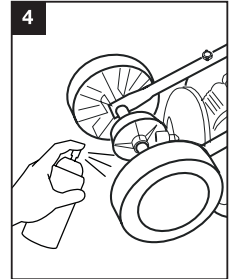
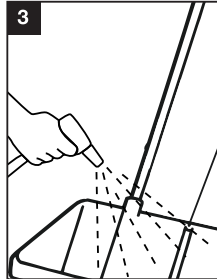
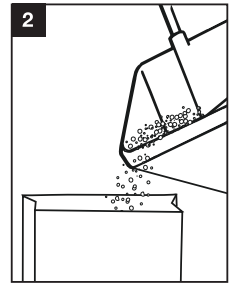

Parts and Replacement

We are pleased to offer a parts replacement service please contact our consumer careline **01276 401300**, visit **lovethegarden.com** or email **consumercarelineuk@evergreengarden.com** for more information

Evergreen Garden Care UK Ltd, 1 Archipelago, Lyon Way, Frimley, Surrey, GU16 7ER

Tel: 01276 401300

lovethegarden.com

